



A project by



ADDRESS OF SIGNIFICANCE

SITE ADDRESS: - GH2, SECTOR 88-89 DIVIDING ROAD, MOHALI
CORPORATE OFFICE - SCO 11-12, FIRST FLOOR, SECTOR 79, MOHALI

Disclaimer : The image/information is merely artistic conceptualization and does not replicate the exact product and should not be relied upon as definitive reference. Nothing mentioned herein intends to constitute a legal offering and doesn't form part of any agreement or legal binding on The Horizon Group (Horizon Infrastructure & Developers LLP). Information may contain technical inaccuracies or typographical errors.

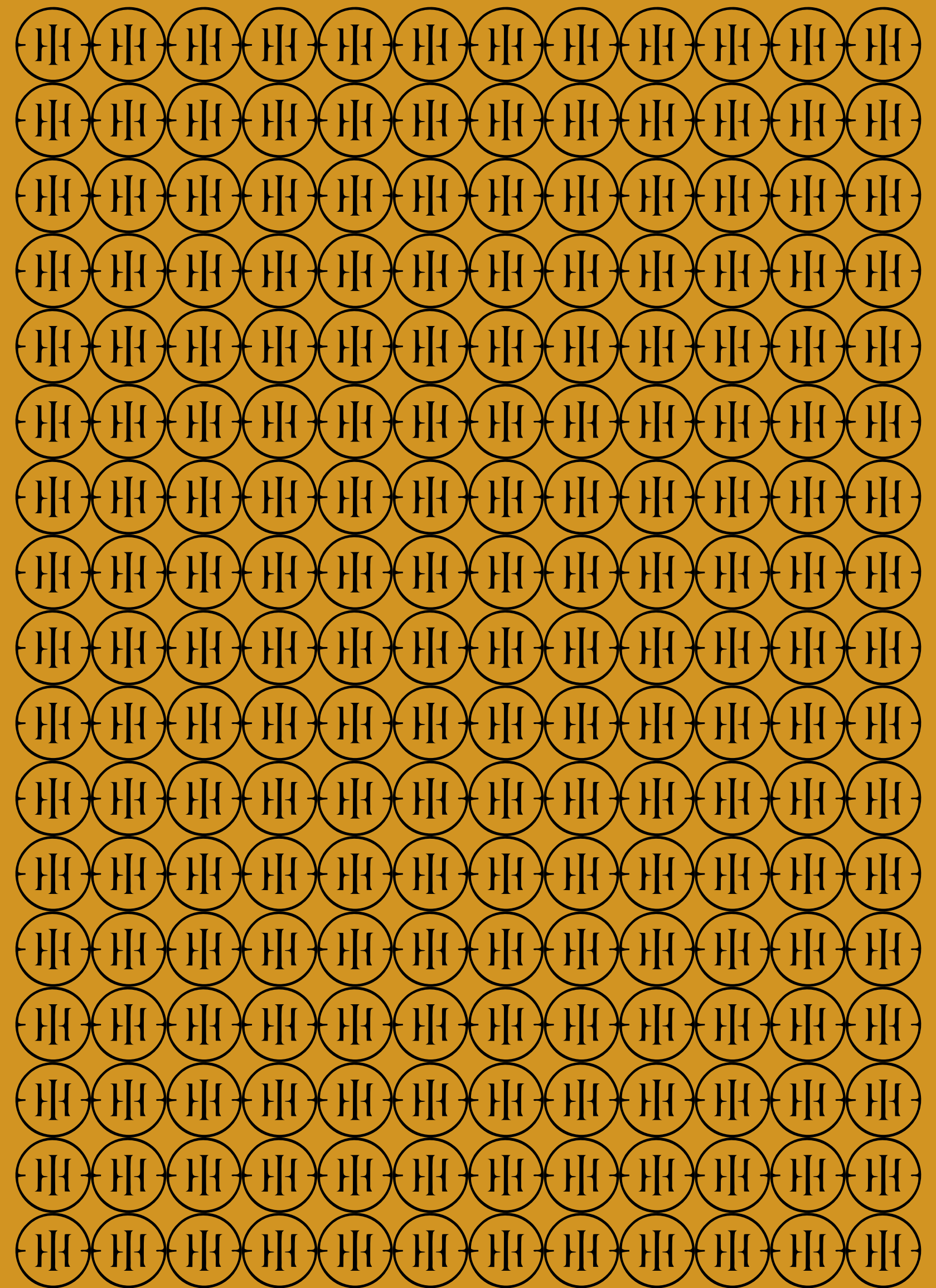

AWAKEN TO
THE BREATH OF FRESH AIR,

TRANSPORT
YOURSELF TO A LAND OF BLISS,

EXPERIENCE
THE REALM OF PRIVILEGE



HORIZON
BELMOND
ADDRESS OF SIGNIFICANCE



ADDRESS OF SIGNIFICANCE

Punjab – the land of the five rivers – *Chenab, Ravi, Jhelum, Beas, and Sutlej* has always been India's frontier region in the North West, since the Greeks and later the Turko-Mughals. Punjab is a land famous for its lush green fields, rich history and traditions. The culture of Punjab has its own unique fragrance. It is unsurpassed. The Vibrancy, the Charm, the Positivity, the Spontaneity is almost infectious!

A milieu of culture, luxury and lifestyle Horizon Belmond will open the gates to a truly enhanced and aspirational lifestyle, fostered with a culture of timeless elegance is all set to become one of the rare and significant address of Punjab.

MOHALI- THE FUTURE CITY OF PUNJAB

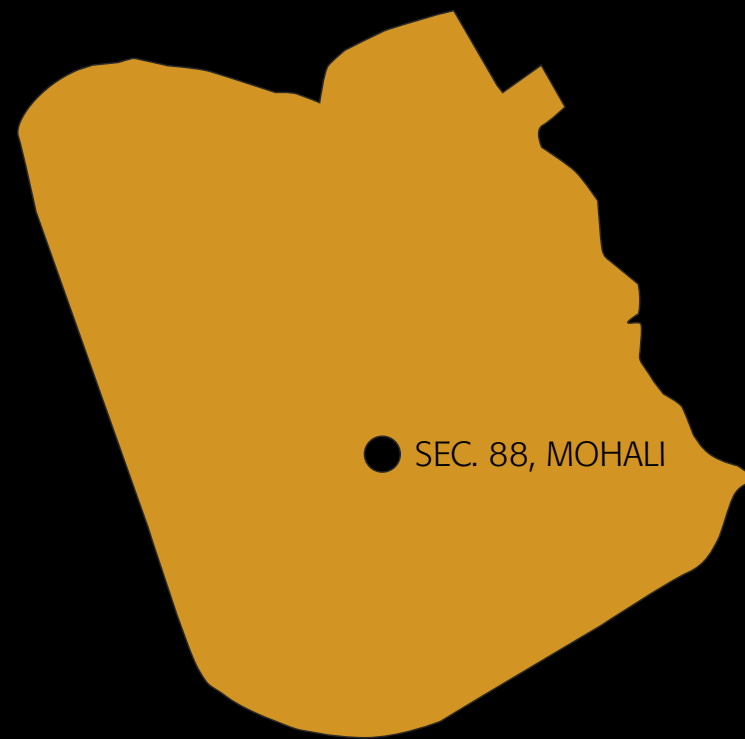

Picturesquely located at the foothills of Shivaliks, Chandigarh is known as one of the best experiments in urban planning and modern architecture in the twentieth century in India .

Mohali - the satellite city has so much for you to admire about. With peace at every corner, sweeping view of lush green mountains and clean wide roads, the city is a shopper's paradise and a popular IT and commercial hub for the country.

With outstanding public infrastructure in the prime sector 88 of Mohali, Horizon Belmond will set new standards with an unmatched lifestyle experience.

PLANNED CITY

WELL CONNECTED

INTERNATIONAL AIRPORT

MEDICAL FACILITIES

SCHOOLS & UNIVERSITIES

SPORTS HUB

IT HUB

SHOPPING MALLS

HISTORICAL MONUMENTS

AN ACHIEVER'S DREAM,
A CONNOISSEUR'S PARADISE



Horizon Belmond means Beautiful, is our exclusive residential offering, is an exemplification of this thought, with an artful setting of diverse elements both formal and functional.

The Horizon Belmond precinct offers seven exclusive Belmond Towers inspired by the name itself and inspired from the significant, all glorious and royal state of Punjab, where hybrid history and architecture come together.

The Kōh-i Nūr which means "Mountain of Light" in Persian, also spelled Koh-i-noor, Koh-e Noor or Koh-i-Nur is one of the largest and the most prestigious known diamond in the world and was once the prized possession of Sher-e-Punjab Maharaja Ranjit Singh.

Presenting the all splendid **Koh-i-Noor – THE LIMITED EDITION 5 BHK EXCLUSIVE DUPLEX RESIDENCES COLLECTION**. With personal lift, generously appointed double height living rooms, large sun decks and much more with sophisticated finishes and curated interiors, they afford you the space you need to be whoever you want to be.



Let the wind carry the whisper from your lips,
let it make true your every wish.
Let your desires be fulfilled at just a glance,
come to where nothing is left to chance.
Come to a paradise that never ceases to amaze,
to live a dream in your very own space.
Come to life in a different dimension,
in the heart of the city of excitement.

An apt destination you will own with pride,
we welcome you to Horizon Belmont

Experience the ethereal life at Horizon Belmond, where every little moment is curated only for the true connoisseurs. Step into this Luxury Expanse that you can call home.

It is the time to live your dreams. For life is much more than it seems. For the truly discerning, the creations are in a class of their own.

What are you waiting for?





A SCULPTURAL STATEMENT
SO POWERFUL, IT WILL TRANSFORM
MOHALI'S SKYLINE FOREVER.



DESIGNED FOR LIFE.



The apartments at Horizon Belmont elevate your elite lifestyle with the thoughtfulness of the layout and the meticulousness of finishes.

Horizon Belmont is a rich landscape designed to provide a multitude of experiences and a diverse range of delightful environments. Pulsating with vibrant life and activity, and so rich in experiences, that it would take a lifetime to enjoy all of them.





A STUNNING G+24
STORY LUXE APARTMENTS
LOCATED IN THE MOST
PRIME AREA OF MOHALI

Discover a restorative retreat for the mind, healthful activities for the body, and elegant spaces for the social connection. Find life at home where it should be, naturally in balance. Modern High Quality Design, Plentiful and Luxurious Amenities to enhance a healthy and fulfilling Lifestyle, in the most Energetic & Vibrant Community in Mohali.

Belmond Drive - Cruise through a whole world of conveniences right at your door step. As the revitalized centre of the project, Belmond Drive will offer everything consumers could possibly ever need, and so much more. Designed as a lifestyle drive, it will feature specialty outlets, services and restaurants to cater to the growing lifestyle needs of the residents.



Both side open
apartments

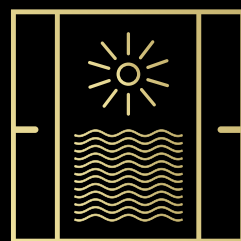

Ample sunlight and
natural ventilation

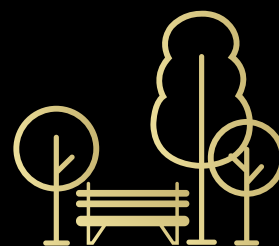

All the flats
are green facing



Vastu compliant
project

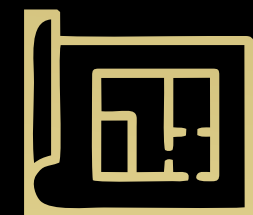

Cluster of two apartments
on every floor



A STUNNING DROP OFF
EXUDES REFINED LUXURY
FROM THE MOMENT
YOU APPROACH THE
ICONIC TOWER.

Thoughtfully-crafted and uniquely-designed the foyer and waiting area will leave you in awe and greet you every time you enter the gateway and you will be enchanted by the grandiose that surrounds you.

From the extravagant lobbies to the whisper-soft elevators that whisk you up to your apartment, your world is designed to the highest standards and sensibilities.

REPRESENTATIONAL IMAGE





EXCLUSIVE ON SITE CONCIERGE

Horizon Belmond is a perfect confluence of art and architecture. A place where your everyday life comes punctuated with luxurious amenities like exclusive concierge services and valet parking to make your life effortlessly rewarding.

Experience a bespoke lifestyle by ensuring 'Your Wish is Their Command'.

ULTRA-LUXURIOUS HOMES THAT REDEFINE THE HEART OF FINE LIVING.

Spacious and grand, your residence is meticulously planned and elegantly crafted to offer uninterrupted views and inviting fresh air and natural light, to keep you vivid and cheerful through the day.

At Horizon Belmond, life takes a turn for the better. Enjoy the joys of luxurious living, chase your favorite leisure, spend quality time at home because of its close proximity to your workplace or dream that a weekend lasts forever. The perfect abode for to soak yourself in the sphere of comfort.

AMPLE NATURAL LIGHT AND VENTILATION
SUN DECKS
GREEN VIEWS





NATURE'S BOUNTY TO
WALK-IN AND IMMENSITY
TO DREAM...

WHAT MORE COULD
YOU ASK FOR ?



*Your Space. Where you can walk
unhurriedly, languidly.
Where you can unwind in the luxurious lawn.
A place where even time celebrates space
and privacy.*

Often, it's the painters or poets who take
you to the land where a rippling brook is
meandering through a vast expanse of land
or a series of trees are branching out to make
arched pathways.

Now experience this picturesque view
at Horizon Belmond. Explore every shade
of nature within the vicinity of your home.





CLUB STARDOM 
enjoy every moment

Step into the epicentre of leisure at the exceptional Club Stardom, at Horizon Belmond – is one of most exclusive indoor clubs, that houses all you want from sports and recreational facilities to lifestyle and fine dining.

It's not any ordinary club. It's a spectacle, a work of art that will leave you awe-struck every time you step in.

A modern residential building at dusk. The building features a prominent glass-enclosed structure, likely a clubhouse or pool area, and a garden with trees and people. The sky is a deep blue, and the building's lights are on. The text "ENJOY EVERY MOMENT" is overlaid on the image.

Whether you want to play your favourite sport or step out with your loved ones for a leisurely time or simply take a break from the kids and enjoy a nice cup of coffee in solace, Club Stardom is the ultimate destination for you and your loved! It aspires to create a world where everyone is welcomed to celebrate, play, laugh and create memories together.

ENJOY EVERY MOMENT

CLUB STARDOM
enjoy every moment



ALL WEATHER INDOOR SWIMMING POOL

Don't let the blues get to you.

Take a dip into the pool whole year around and befriend tranquility as all your qualms get washed away by the calm of the pool.



RESTAURANT & COFFEE SHOP

Sip in your cup of coffee with friends or snuggle yourself in a cozy corner over a few pages of your favourite book or spend an evening together with your loved ones in the cozy and plush interiors here amidst unmatched service.



FULLY EQUIPPED GYMNASIUM



WELL STOCKED LIBRARY



BANQUET HALL



GO BEYOND YOUR LIMITS.

Remember that new year resolution you made? It's time to stick to it at the fully equipped gym. You'll find all the latest machines, from treadmills to abs-worker to crossfit equipment to gym stations – everything you need for cardio as well as strength training. Work everything out for all you're worth. And when you need to bring your racing heart down to normal, there's always the yoga room to calm down.

STATE-OF-THE-ART GYMNASIUM
AEROBICS/YOGA ROOM



SUSTAINABLE LIVING FOR NOW AND FOR THE FUTURE

The world doesn't belong to us. We have just borrowed it from our children. It is this belief that has driven us to create an eco-friendly lifestyle at Horizon Belmond with conservation systems like rain-water harvesting, solid waste management and a sewage treatment plant amongst many others.

SOLID WASTE MANAGEMENT
RAINWATER HARVESTING PITS TO RECHARGE GROUND WATER TABLE
SEWAGE TREATMENT PLANT



OPEN AIR FACILITIES FOR EVERY SPORT



Horizon Belmond offers you a chance to indulge your athletic side with courts for every sport. It offers the perfect sporting getaway for friends and families alike. Whatever you're playing, you'll find enough activity to keep you going every everyday.

MULTI-PURPOSE SPORTS COURT
MULTIPLE SPORTS FACILITIES
ACTIVITY ROOM



LIFE IS TOO SHORT TO SPEND BORING EVENINGS.



Life at Horizon Belmond can be a large dose of fun. There's endless rounds of pool, cards and other games in the games room or you could invite friends over for a party at the fully equipped and lavishly appointed banquet hall. Of course, kids can have their own little party in the kids' play area.

GAMES ROOM | POOL ROOM
KIDS' PLAY AREA | BANQUET HALL



LOCATION MAP





SITE PLAN



SITE PLAN OVERVIEW

- 01. ENTRY / EXIT
- 02. BLOCK-01: 4BHK (S+24 FLOORS)
- 03. BLOCK-02: 3BHK (S+24 FLOORS)
- 04. BLOCK-03: 5BHK (S+24 FLOORS)
- 05. CLUBHOUSE/ SWIMMING POOL
- 06. MEDITATION AREA
- 07. OPEN AIR THEATRE
- 08. SENIOR CITIZEN AREA
- 09. METAL TREE SCULPTURE/MIST FOUNTAIN
- 10. GAZEBO
- 11. PLAZA
- 12. WATER FEATURE
- 13. OPEN AIR GYM
- 14. BADMINTON COURT
- 15. KID'S PLAY AREA
- 16. CRICKET PITCH
- 17. BASKETBALL COURT
- 18. JAPANESE GARDEN
- 19. PET GARDEN
- 20. PARTY LAWN



The logo is translation of our vision to reach the pinnacle at Horizon, where our dreams and aspirations meet. The Circle is inspired from SUN signifying energy, power, positivity, clarity and high spirits.

The logo is a juxtaposition of alphabets H.O.R.I.Z.O.N which forms the part of the logo and symbolizes the company characteristics and provides us with a distinguishing image which symbolizes the expression of perfection, standards of excellence and brilliance.

Our ethos and quest for finesse is represented by combining black and golden color signifying prestige, luxury, royalty and elegance.

innovation
excellence
quality growth



Driven by the passion to create perfect harmony in everyday living, Horizon Group combines the beauty of natural elements with contemporary design and elegance to create enduring architecture that carries a lasting appeal.

Aspiring to be one of Mohali's leading luxury developers, we believe that architecture has the power to enrich our lives like nothing else can. Efficiently managed and executed by our in-house team of experts to match Horizon's exacting standards, we work closely with our network of top artisans and construction craftsmen who value fine workmanship as highly as we do. In terms of aesthetics, location, material or workmanship nothing but the world's very best works for Horizon Group, customers – you!

when the built
form turns into an art

Good design inspires us. We believe that the built form is an art that must reflect the sensibilities of the occupants who are eventually going to live in that space.

Instead of seeing architecture and construction as two separate processes at Horizon Group we see it as a unified, seamless activity, right from the onset of a project to the finish, resulting in smart, streamlined outcomes.

Throughout a project's building journey, our team is guided by the aspirations of our valued customers, who are going to live in the projects that we aesthetically conceive and deliver to them.



creating a stellar oasis of luxury



HORIZON BELMOND
INTERIOR CONSULTANT

SUSSANNE KHAN



The first collaboration of Sussanne Khan in this part of the country is all set out to create an elegant, timeless lifestyle experience in Mohali - something that echoes the qualities of a modern, elegant and luxury interiors. It is the unconventional, symphonic interplay of carefully selected objects and thematic contrasts: exciting and peaceful, strange and familiar, modest and flamboyant, local treasure market finds and design classics. It is the "solitaire" planning in which each object & element hides the valuable essence of our work: Precision, Craftsmanship & Luxury.

Sussanne Khan is one of the acclaimed interior design minds in India, having established her own interior design studio and store - The Charcoal Project - India's first and most unique design concept store changing the meaning of curate interior design in India.

partners

Vastu refers to using the right proportions of nature's five elements - Fire, Air, Earth, Water & Sky and synchronization of body mind and soul with nature.

Horizon Group in collaboration with Mahavastu Acharya Shreel Goyal - a prominent consultant in the field of Vastu, has laid the foundation of construction guidelines that will vibrate in harmony with nature & balances the flow of cosmic energy (prana) through & around.

SHREEL GOYAL, MAHAVASTU ACHARYA

Horizon for the first time in Up-North has associated with Collier's International - a globally renowned name in the field of Real Estate Project Management with over 450+ office presence across the globe.

The onsite team of Collier's will overlook the entire project development cycle of Horizon Belmond including construction planning and execution, procurement of raw material, construction cycles, finishes to deliver spaces that are completely ready to occupy.

PROJECT MANAGEMENT, COLLIERS INTERNATIONAL

They are our team of experts in design, strategy, positioning and content - Spell Communications is an integral part of Horizon family since its inception. Through its analytical and creative processes, Spell has created a 'lovemark' and effective market communication for Horizon Group.

They always challenge the traditional perception of brand building and create strong and unique identities that can be differentiated from each other.

COMMUNICATION AND STRATEGY, SPELL

other projects



Welcome to the all-new High-Street Shopping destination with a world of Retail factory outlets for the fashionista in you, presenting – Horizon Richmond, located on the main highway, NH205-A is all set to become Mohali’s most promising retail destination. Spread across 5.5 acres – the upcoming hub promises to be the epicentre of shopping, food, fun and entertainment.

The multiple connectivity options from the Airport and Mohali makes the destination an ideal weekend drive with loads of fun and good times in store for everyone. Horizon Richmond is all poised to become the one of its kind High Street experience in Tricity.

#COMINGSOON



With core focus on creating eco-friendly living spaces, building a soothing euphony with nature, ensuring all the comfort and intimacy for the best living experience, Horizon Group presents Horizon GREENSVILLE – a 34 acre integrated gated township with sustainable ecosystem and lifestyle amenities. Next door to Mohali and ideally located in Sector 113 with direct access from NH 205-A, Horizon Greenville offers residential plots, residential floors and business and shopping centre – Horizon Central in the front.

With all the modern and premium amenities required for a peaceful & secure living, Horizon Greenville takes the community level living to the to the next level.

#COMINGSOON